

UHF / TRANSIT ANTENNAS

406-512MHz

Comprod's line of VHF transit antennas is a low profile rugged alternative to $\frac{1}{4}$ wave whips. When mounted on a horizontal surface, maximum radiation is omnidirectional and vertically polarized.

These antennas are an excellent choice for low clearance applications such as those found on trains, public transit vehicles, construction equipment and police vehicles.

The model 359-75 is a high strength cast aluminum design. The antenna can be coated for additional protection against harsh environmental conditions. To ensure a moisture proof installation, the model 359-75 is supplied with an O-ring.

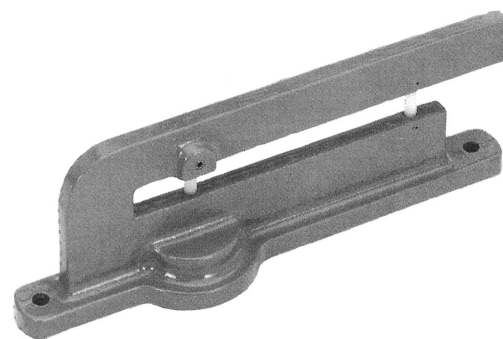

359-75

Electrical Specifications	359-75
Nominal Gain	Unity
Max. Power, Watts	125
Frequency Range, MHz	406-512
Bandwidth VSWR: 1.5:1, MHz	18
Bandwidth VSWR: 2.0:1, MHz	27
Nominal Impedance, Ohms	50
Radiation Pattern	Omnidirectional
Polarization	Vertical
Radome Material	n/a
Connector	UHF / BNC / N Female
Height, in (mm)	2-1/2 (64)
Length, in (mm)	8 (203)
Width, in (mm)	2 (51)
Weight, lbs (kg)	0.75 (0.338)
Min. Ground Plane Size, in (mm)	20 x 16 (508 x 406)

Ordering information

- Specify center frequency
- Specify connector type:
UHF, BNC or N Female

